

# DocuPrint P475 AP

Smart gateway to the new workstyle.



# Intelligent and powerful A4 monochrome printer supporting your smart workstyle.

DocuPrint P475 AP delivers superb printing image quality, high connectivity and productivity, and intuitive user experience with colour touch panel. Caters to a variety of requirements from workgroup to enterprise customers.



## DocuPrint P475 AP



- Intelligent monochrome printer
- Print up to 53 ppm
- 5-inch colour touch panel
- Print resolution up to 1200 x 1200 dpi
- USB, Ethernet, Wi-Fi\*2 connectivity

\*1: Pages per minute.

\*2: Optional.

### Intelligence

- Advanced operability with 5-inch colour touch panel. You can personalize the icons on the screen to make your regular workflow easier and faster.
- Whether as a desktop or a console device, the adjustable touch panel lets you easily operate the device. Comfortable sound and light navigate you to the intuitive user experience.
- You can refer to FAQ and user instructions on **Help screen** when you have questions on how to use. Colour animation on the touch panel assists you to solve the operation troubles easily.

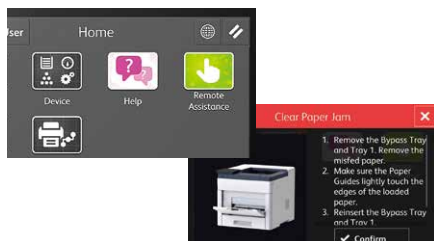

Even if you cannot solve the trouble by yourself, **Remote Assistance** helps you. The call center staff remotely operates your touch panel for trouble shooting.

- Device management and cost control is easy with ApeosWare Management Suite 2\*, which can manage devices and their usages, and provides integrated authentication, print output, and log accounting.

\* Software sold separately. Planned to be supported.

### Connectivity & security

- Perfect for fast-moving mobile workers who need to print out something while on the move. You can easily print from mobile devices using **Print Utility**\*1, **AirPrint**, and **Mopria Print Service**. When using Print Utility, the printing device is identified just by holding your mobile device\*2 over the NFC area on the panel. Easy and simple operation helps busy workers.



\*1: Print Utility is free application provided by Fuji Xerox.

\*2: NFC-enabled device is required.

- Prevents paper information leakage with **Secure Print** and **Private Charge Print** with IC card authentication\*. With Image Log\*, job logs and the image itself can be stored and managed, enabling prompt investigation upon information leakage.

\* Optional.

- 360° security realized with various measures such as communication route encryption, data encryption, access log, and usage restrictions. Reliable partner for your business continuity.

### Productivity

- Attention-grabbing print quality with Super EA-Eco toner and LED Printhead, while offering fast printing of 53 ppm at the same time.
- High reliability with robust design for 600000-page machine life. Tough partner for high-volume printing environment.
- Energy saving with Super EA-Eco toner with low fusing temperature.
- Flexibly caters to your business needs with optional 550-Sheet Feeder and Cabinet. You can expand the paper feeding capability up to 2350\* sheets at maximum.

\* When three 550-Sheet Feeders are installed at maximum. Based on 80 gsm paper.





## User-friendly colour touch panel

When using Private Charge Print, you can easily select and delete the documents viewing the thumbnails shown on the panel. Convenient for saving time and waste.



5-inch colour touch panel



USB port



## Smart & scalable

- 1 5-inch colour touch panel:**  
Intuitive colour touch panel lets you find just what you want at a glance.
- 2 USB port\*:**  
Use your own USB memory to print directly from the USB.  
\* Optional.
- 3 IC card reader\*:**  
You can use Private Charge Print with your IC card.  
\* Optional.
- 4 Bypass Tray:**  
Can print on various paper types such as envelopes and postcards.
- 5 Standard Tray (550 sheets):**  
For standard users. Supports various types & sizes of paper.
- 6 550-Sheet Feeder\*<sup>1</sup> (550 sheets):**  
Paper feeding capacity is 2350\*<sup>2</sup> sheets at maximum. High scalability for high-volume printing needs.  
\*<sup>1</sup>: Optional.  
\*<sup>2</sup>: When three 550-Sheet Feeders are installed.
- 7 Caster\*:**  
For easy installation and moving on the floor.  
\* Optional.
- 8 Cabinet\*:**  
Convenient for storing paper and consumables.  
\* Optional.



# DocuPrint P475 AP Functions & Specifications

## Functions & Specifications

Item	Description
Printing Method	LED Xerography <sup>*1</sup>
Warm-up Time	38 seconds or less (23 degrees Celsius room temperature). 20 seconds or less from Sleep Mode.
Continuous Print Speed <sup>*2</sup>	Simplex 53 ppm Duplex 34.3 ppm
First Print Output Time <sup>*3</sup>	6.0 seconds (A4)
Printing Resolution	Standard [PCL Driver] Standard: 1200 x 1200 dpi, High Resolution: 1200 x 1200 dpi, High Quality: 1200 x 1200 dpi
	Optional [Adobe® PostScript® 3™ Driver] Standard: 1200 x 1200 dpi, High Resolution: 1200 x 1200 dpi, High Quality: 1200 x 1200 dpi
Paper Size	Standard Tray A5, JIS B5, ISO B5, A4, Statement (139.7 x 215.9 mm), Executive (184 x 267 mm), Letter, 8.5 x 13" (215.9 x 330.2 mm), Legal, Custom Size (Width: 76.2 to 215.9 mm, Length: 190 to 355.6 mm)
	Bypass Tray A6, JIS B6, A5, A5 LEF, JIS B5, ISO B5, A4, Statement (139.7 x 215.9 mm), Executive (184 x 267 mm), Letter, 8.5 x 13" (215.9 x 330.2 mm), Legal, COM-10, Monarch, DL, C5, Custom Size (Width: 76.2 to 215.9 mm, Length: 127 to 355.6 mm)
	Optional Tray 550-Sheet Feeder: A5, JIS B5, ISO B5, A4, Statement (139.7 x 215.9 mm), Executive (184 x 267 mm), Letter, 8.5 x 13" (215.9 x 330.2 mm), Legal, Custom Size (Width: 76.2 to 215.9 mm, Length: 190 to 355.6 mm)
	2 Sided Printing A4, JIS B5, A5, Letter, 8.5 x 13" (215.9 x 330.2 mm), Legal, Executive (184 x 267 mm), Custom Size (Width: 139.7 to 215.9 mm, Length: 203.2 to 355.6 mm)
Paper Weight <sup>*4</sup>	Standard Tray 60 to 220 gsm
	Bypass Tray 60 to 220 gsm
	Optional Tray 550-Sheet Feeder: 60 to 220 gsm
	2 Sided Printing 60 to 176 gsm
Paper Tray Capacity <sup>*5</sup>	Standard Standard Tray: 550 sheets Bypass Tray: 150 sheets
	Optional 550-Sheet Feeder: 550 sheets
	Max 2350 sheets [Standard + 550-Sheet Feeder x 3]
Output Tray Capacity <sup>*5</sup>	250 sheets
CPU	ARM Dual Core 1.3 GHz
Memory Capacity	2 GB (Max: 2 GB)
Storage Device Capacity <sup>*6</sup>	3.6 GB, Optional: 128 GB <sup>*7</sup>
Page Description Language	Standard PCL5 / PCL6 Optional Adobe® PostScript® 3™
Supported Operating System <sup>*8</sup>	Standard [PCL Driver] Windows 10 (32 bit / 64 bit), Windows 8.1 (32 bit / 64 bit), Windows Server 2019 (64 bit), Windows Server 2016 (64 bit), Windows Server 2012 R2 (64 bit), Windows Server 2012 (64 bit) [Mac OS X Driver] macOS 10.15 / 10.14 / 10.13 / 10.12, OS X 10.11
	Optional [Adobe® PostScript® 3™ Driver] Windows 10 (32 bit / 64 bit), Windows 8.1 (32 bit / 64 bit), Windows Server 2019 (64 bit), Windows Server 2016 (64 bit), Windows Server 2012 R2 (64 bit), Windows Server 2012 (64 bit) macOS 10.15 / 10.14 / 10.13 / 10.12, OS X 10.11
Interface	Standard Ethernet 1000BASE-T / 100BASE-TX / 10BASE-T, USB3.0, USB2.0
	Optional Wireless LAN (IEEE 802.11 a / b / g / n / ac)
Network Protocol	TCP/IP (lpd, IPP, Port9100)
Power Supply <sup>*9</sup>	AC220-240 V +/- 10 %, 8 A, 50/60 Hz common
Operating Noise <sup>*10,11</sup>	In Operation: 7.1 B, 56.0 dB (A) Ready Mode: 4.2 B, 26.3 dB (A)

### Notes

- To comply with paper weight specifications, it is recommended to use Fuji Xerox recommended paper. Document may not be printed correctly depending on usage conditions.
- Functional spare parts will be available for at least 7 years after the product is no longer manufactured.

Apple, iPhone, AirPrint, iPad, iPad Air, iPad Pro, iPod touch, and Mac are trademarks of Apple Inc., registered in the U.S. and other countries.

All product names and company names mentioned in this brochure are trademarks or registered trademarks of their respective companies.

The product specifications, appearance and other details in this brochure are subject to change without notice for improvements.

The available model varies depending on the country/region. Please ask the sales representatives for details.

**Reproduction Prohibitions** Please note that reproduction of the following is prohibited by law: Domestic and foreign currencies, government-issued securities, and national bonds and local bond certificates. Unused postage stamps, post cards, etc. Certificate stamps stipulated by law. Reproducing works forming the subject matter of copyright (literary works, musical works, paintings, engravings, maps, cinematographic works, drawings, photographic works, etc.) is not permitted unless the reproduction is for the purpose of personal use, family use or other similar uses within a limited circle.

For more information or detailed product specification, please call or visit us at

## Fuji Xerox (Hong Kong) Limited

11/F 12 Taikoo Wan Road, Quarry Bay, Hong Kong

Tel. 852-2513-2513

<https://www.fujixerox.com.hk/>

Item	Description
Maximum Power Consumption	Max 1340 W
	Sleep Mode 0.5 W
	Average Ready Mode: 53 W, In Operation: 732 W
Dimensions	W 427.4 x D 465.5 <sup>*12</sup> x H 407.4 <sup>*13</sup> mm
Weight <sup>*14</sup>	21.6 kg (Including consumables and drum)
	20.0 kg (Excluding consumables and drum)

\*1: LED + Xerographic.

\*2: When Continuously Printing Original in A4 (Plain). The performance may be reduced depending on the paper type and the paper size. The speed may be reduced due to the image quality adjustment.

\*3: When feeding from feeder tray of machine. Numeric value varies depending on output environment.

\*4: It is recommended to use Fuji Xerox recommended paper. Correct print output may not be possible depending on the requirement.

\*5: 80 gsm paper.

\*6: The Storage Device Capacity is not totally available for customers.

\*7: When the optional Storage (SSD) is installed.

\*8: Please refer to our official website for the latest supported OS.

\*9: Power outlets that provide the above power level is recommended. Maximum machine measured current: 8 A.

\*10: Measured in accordance to ISO7779. Unit B: Sound Power Level LWAd. Unit dB: Radiated Sound Pressure Level LpAm (bystander position).as reference value.

\*11: Main unit only.

\*12: CI Badge is excluded. When CI Badge is included, 2.7 mm is added.

\*13: 550-Sheet Feeder (height): 123 mm (The height increment when the option is installed).

\*14: Including Toner Cartridge, 550-Sheet Feeder: 6.6 kg.

## Options

Product Name	Product Code
550-Sheet Feeder	EC103493
Caster	EC103495
Cabinet	EL500294
Wireless LAN Kit	EC103915
Storage (SSD)	EC103918
Foreign Device Interface A-14	E9100157
Adobe® PostScript® 3™ Kit	EC103956
Adobe® PostScript® 3™ Kit label	ED201136
Multi-Language Font Kit	EC101145
USB Memory Kit	EC103982
Security Expansion Kit	EC103963
Network Accounting Kit	EC103984
TC/SC Additional Font ROM Kit	EC103986
External IC Card Reader B	EC103320

## Consumables

Product Name	Product Code	Product Life
Drum Cartridge Black (Starter)	—	Up to 60,000 pages <sup>*1</sup>
Drum Cartridge Black	CT351230	Up to 60,000 pages <sup>*1</sup>
Toner Cartridge Black (Starter)	—	Up to 6,000 pages <sup>*2</sup>
Toner Cartridge Standard Black	CT203365	Up to 10,000 pages <sup>*2</sup>
Toner Cartridge High-capacity Black	CT203366	Up to 24,300 pages <sup>*2</sup>
Fusing unit 220v	CWAA0959	Up to 200,000 pages
BTR	EC103508	Up to 200,000 pages
Paper Roller Kit	EC103505	Up to 100,000 pages

\*1: The number of printable pages is a reference value derived from the average of 3 sheets printed in A4, 1 sided, image coverage per 5 % in one setting, under continuous printing usage conditions. The actual number of printable pages may vary to below half the reference value, depending on paper type, paper direction, input/output tray settings, initialization operations upon powering ON/OFF the device, tuning operations to maintain print quality, and other such usage environment conditions.

\*2: Published value based on ISO/IEC 19752 standards. The actual number of printable pages may vary significantly from the published value, depending on printing content, paper size, paper type, usage conditions, initialization operations upon powering ON/OFF the device, tuning operations to maintain print quality, and other such usage environment conditions.



### For Your Safety

Before using the product, read the Instruction Manual carefully for proper use. Use the product with the power source and voltage specified. Be sure to establish ground connection. Otherwise, electronic shock may result in the case of a failure or short circuit.

